

Mounting Instructions

HÄFELE

Item No.: 634.44 series

Medio Table System

Please be sure you have the following components before assembling the table (see diagram below):

- (1) Top Frame
- (1) Left hand side base
- (1) Right hand side base
- (1) Cross Beam with 2 plastic end caps
- (1) Control Box
- (1) Control Switch
- (1) Power Cord
- (2) Motor Cables
- (4) pcs. M8x10 countersunk flat head bolts
- (4) pcs. M6x10 round head bolts
- (8) pcs. M6x8 cylinder head bolts

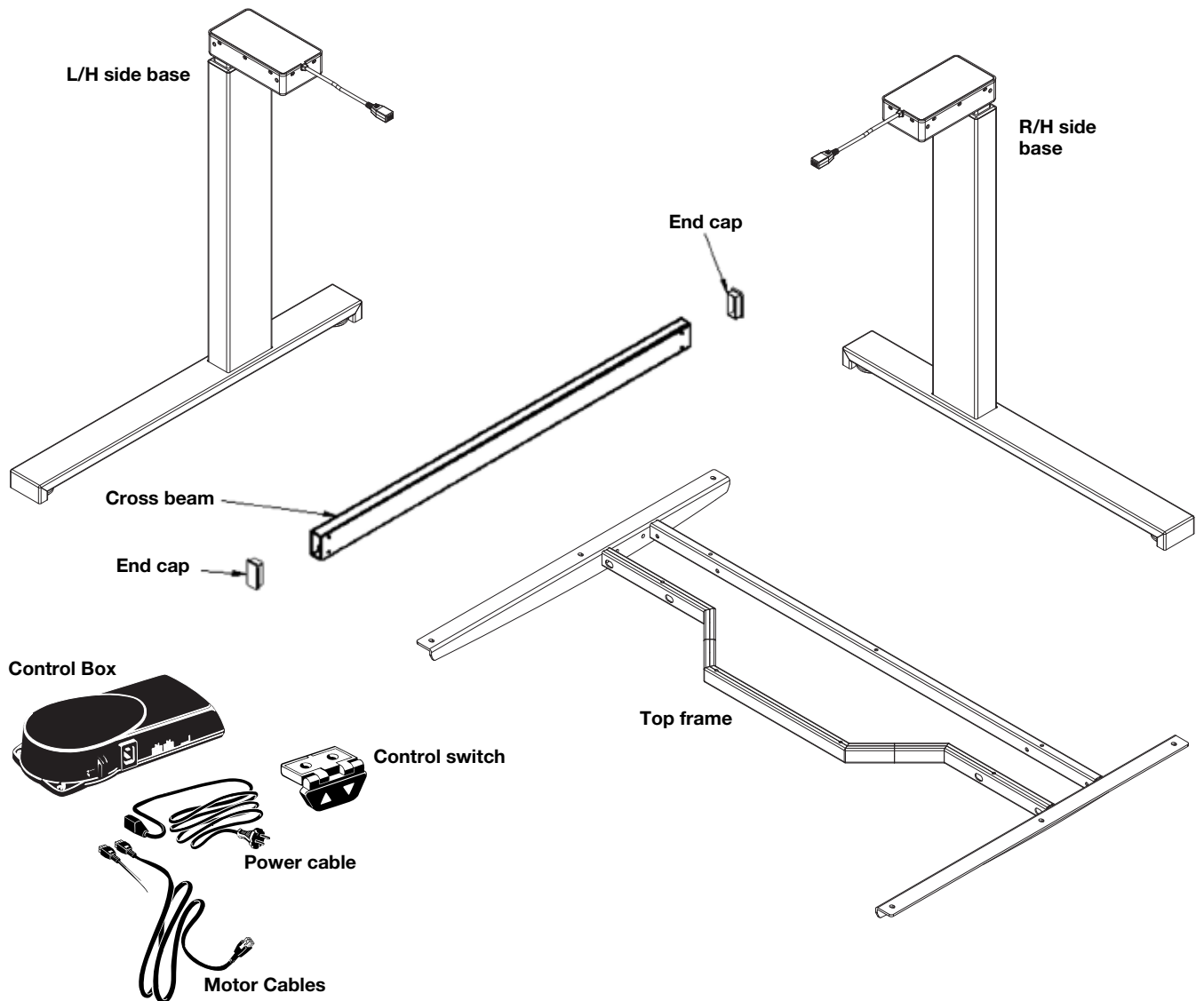

Note: Not included are screws for attaching control box, control switch, or screws for attaching tabletop to frame.

Mounting Instructions

1) Attach the Cross Beam to Side Bases (See diagram 2):

Note that the angles on side bases should be facing the inside. Cover caps may have to be pried loose from beam first. Attach beam to side bases using 4 pcs. of the M8 x 10 countersunk bolts, feed them inside of tube and through holes. Align with attachment plates on side bases and tighten bolts securely. Place square caps over ends of rail and gently tap into place with a mallet.

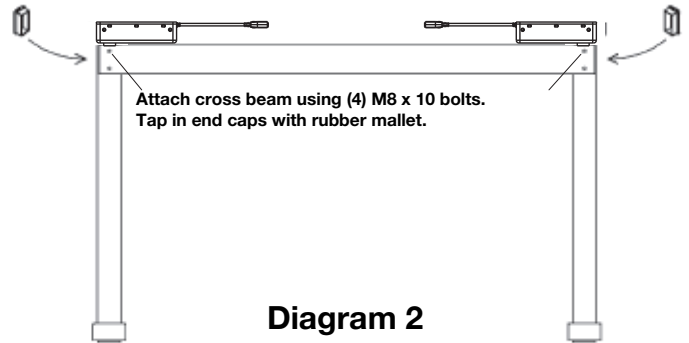

2) Attach Top Frame (See diagram 3):

Place the frame onto the leg structure and bolt in place using 12 pcs. M6 round head bolts. Start with the outside bolts first, then bolt the front and back. Be sure to securely tighten all bolts.

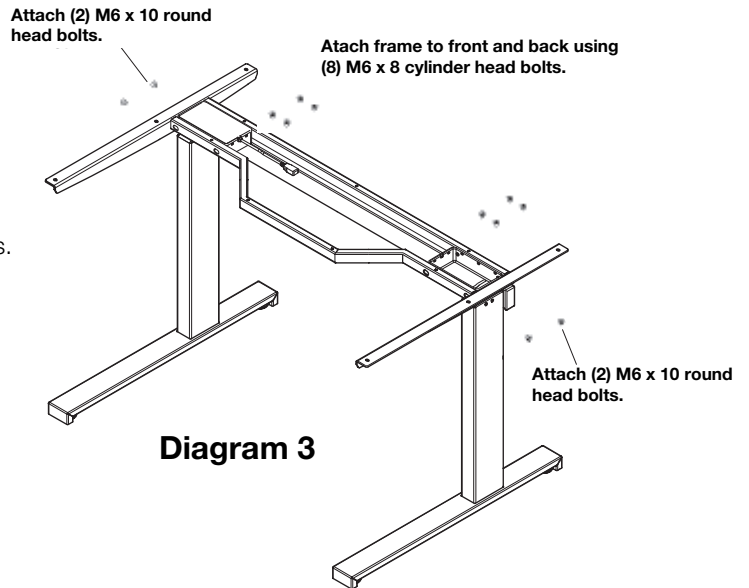

3) Plug Cords Together (See diagram 4):

Plug 6-pin motor cables into the control box at positions '1' and '2' as marked on the control box. Then plug the opposite end of each motor cable into the cable lead of each side base leg. Next, plug the control switch into data jack on the control box. IMPORTANT: The final connection will be to plug the power cord into the AC jack on the control box. This will insure that the control box detects whether both side bases have been properly connected.

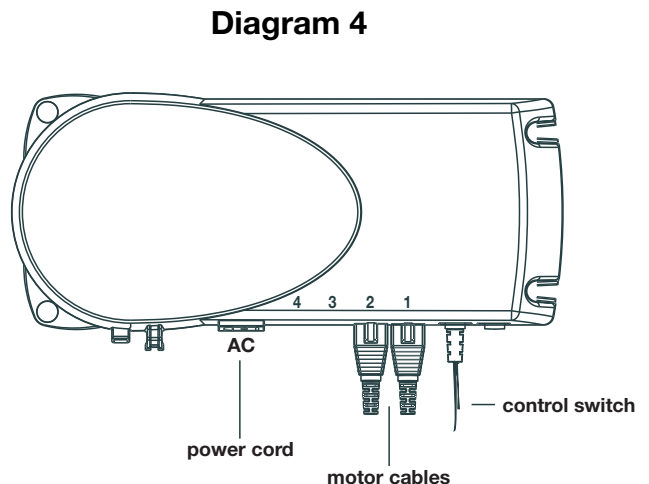

Mounting Instructions

4) Attach Tabletop

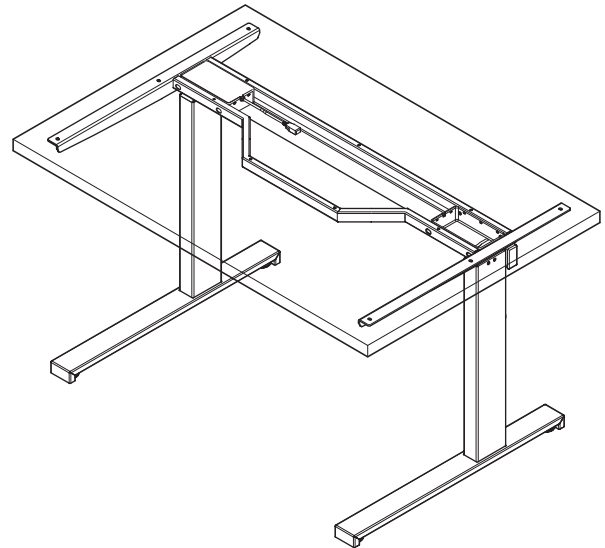

5) Install control box and control switch under the tabletop at desired location.

Initial operation:

- Make sure all electrical wires are connected properly.
- Plug in power cord.
- Press and hold the 'down' key on the control switch – hold the key until the unit travels to a complete stop; it will then automatically travel upward approximately 3 mm. Only release the down key when the movement has completely stopped.

CAUTION:

Make sure there are no objects, persons or their body parts between the tabletop and the cross beam.

Trouble shooting:

- During initial operation of the table, if the down key is released before the sequence is complete then the circuit is interrupted and must be repeated from the beginning.
It may be necessary to press the down key twice to start the initial operation.

HÄFELE

3901 Cheyenne Drive

P.O. Box 4000

Archdale, NC 27263

1-800-423-3531

www.hafele.com