

Item No.: 238.40.012

## Cabinet Installation – 4 pack Cabinet

Ensure that an existing YNOTLOC® is installed within 1 meter of the new locks desired position to provide power to it.



The sensor will work with a maximum gap of 30mm between sensor end and magnetic wand

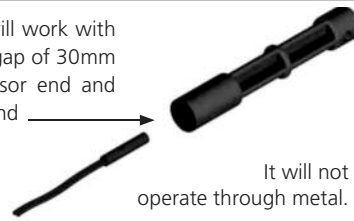

It will not operate through metal.

Check that the strike is orientated correctly so that the flat face of the strike is against the face of the closed door. If it isn't, remove the blue installation tool by rotating it counter-clockwise, and pulling it out of the lock. Turn the strike and installation tool to the right orientation and reattach it by turning clockwise.

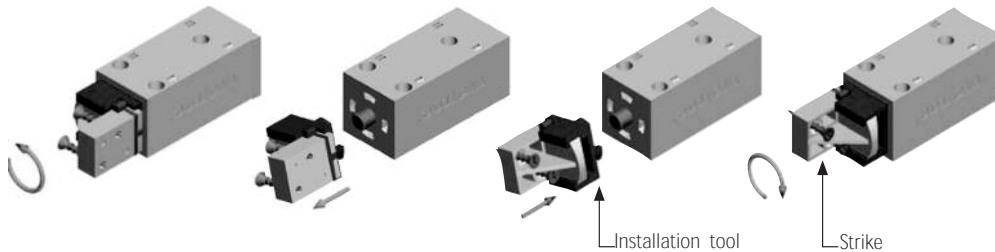

### 1 INSTALLING THE LOCK ASSEMBLY

Use a No.2 Philips head screwdriver to secure lock assembly up into the cabinet frame, as far away from the hinges as practicable remembering that the strike needs to go onto door. Choose a location that allows the door to close within 3mm of the lock assembly face.

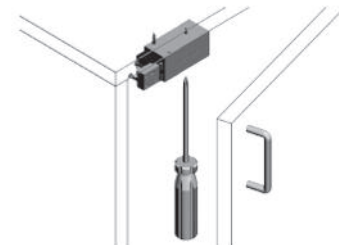

### 2 CONNECTING THE POWER

Plug a jumper wire into any one of the three large slots in the rear of the newly installed lock and plug the other end into your existing lock, which in turn will be plugged into an AC outlet.

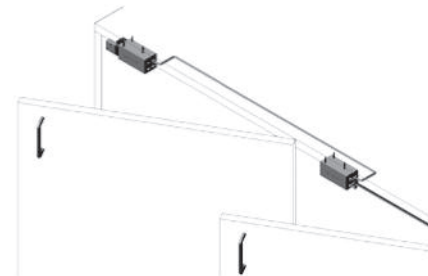

### 3 CONNECTING THE SENSOR

Plug a sensor into the small slot on the rear of the lock. Use a cable-clip to secure the sensor to the desired position inside the cabinet, and provide end-to-end alignment with the magnetic wand. The sensor must not be mounted near any metal parts, and must be at least 50mm away from the lock and any other sensors. Close the door and hold the magnetic wand adjacent to the hidden sensor to test lock operation. If the lock doesn't operate, open the door, and reposition the sensor.

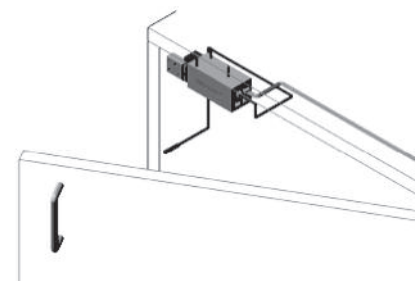

#### 4 INSTALLING THE STRIKE

By closing the door the screws fitted into the strike will leave indentations to indicate its position. If there are no marks, slightly tighten the screws to extend their points further and try closing the door again. Once the strike position has been marked, rotate and remove the blue installation tool and slide the strike off it. Discard the blue installation tool. Screw the strike in place using a No.2 Philips head screwdriver using the shims as necessary. Use the red slider on the strike to override the lock allowing free access to your cabinet.

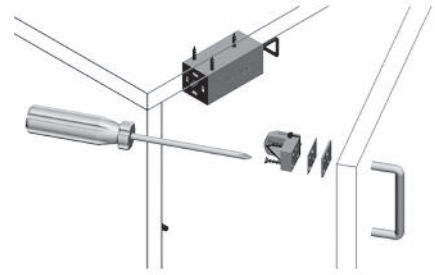

#### 5 ADDING MORE LOCKS

Continue adding locks using the same procedure as described in steps 1-4, using the jumper wires supplied to power each lock from the previous.

Use the cable clips to keep the wires secure and neat.

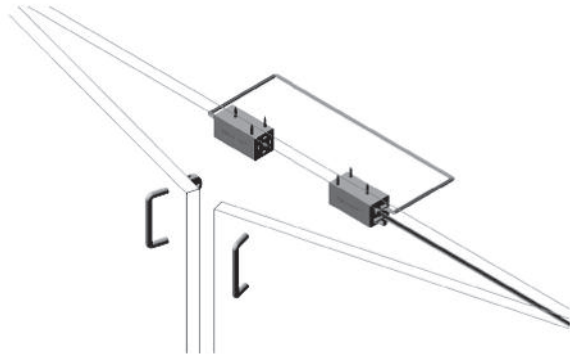

Do you want a safer home?

**YNOT UPGRADE** – Move up from the Starter Pack to the 4 Lock Pack.

Do you need further locking solutions?

**YNOT LOGON** – Go to [www.hafele.com](http://www.hafele.com) to see additional products.

The **YNOTLOC**® system is designed and manufactured by Magna Ltd and distributed exclusively by Häfele America Co. **YNOTLOC**® is a trademark of Magna Ltd, used under license by Häfele America Co. For further information, telephone 1-800-423-3531 or visit [www.hafele.com](http://www.hafele.com).

The child-safe is designed to keep your cupboards and drawers locked and secure, but there is no substitute for proper adult supervision. Keep the magnetic wand out of reach of children, and ensure that it is not accidentally locked away. Magna Limited will not be liable for any direct, indirect, incidental or consequential loss or damage in any way related to the product.

**CAUTION:** The magnetic wand contains a very powerful magnet; so do not place near Televisions, Videos, Credit Cards, Computer hard drives etc.

## YNOTLOC®

PATENTED New Zealand numbers 528984, 528985, 529152. UK patent number 2423116.  
Worldwide patents pending. © Copyright Magna Limited

## HÄFELE

3901 Cheyenne Drive  
P.O. Box 4000  
Archdale, NC 27263  
**1-800-423-3531**  
**www.hafele.com**