

Item No.: 545.47.241, 243

BASE FILLER PULL-OUT

Always read the instructions carefully and completely before beginning assembly.
Remove and check contents for damage and/or missing parts.

Item# 545.47.241- 3" Base Filler Pull-Out
Item# 545.47.243- 6" Base Filler Pull-Out
Box Contents: 1 pc . Base Filler Pull-Out
4 pc. Door Bumpers

You will need:
Safety Glasses
Tape Measure
Screw Driver
Double Sided Tape Pads
Wood Screws with Washers for Door Mount



Installation Instructions

- STEP 1- Locate Unit onto side of first Cabinet, keeping front edge flush with top and face of the Cabinet's frame. (Do NOT align with the front of the temporary Front Stabilizing Panel) See Fig.1
- STEP 2- Attach with wood screws through the Cabinet's side panel into the Unit's Fixed Frame. Note that spacers will be needed between the Cabinet's side panel and the Unit's Fixed Frame in Face Frame Cabinet installations. See Fig.2 (IMPORTANT: Do not allow the Pull Out Unit to protrude past the cabinet's face frame or Door will not close properly).
- STEP 3- Repeat for attachment to Second Cabinet. See Fig.3
- STEP 4- Remove and discard the temporary Front Stabilizing Panel. Insert Door Bumpers into the holes left in the Unit's Frame. See Fig-4
- STEP 5- Attach Cabinet Door or Filler Facia to Unit (Not included). Place 4 pads of double sided tape onto Unit's Front Panel. See Fig.5. Align Door or Filler Facia as desired. Mount door with 4 wood screws and washers through the elongated slots in the Unit's Face Panel into the Door or Facial Panel. See Fig.6. (Important! Use caution on your fastener length to avoid protrusion through the Door or Facia Panel).



Fig.1



Fig.2



Fig.3

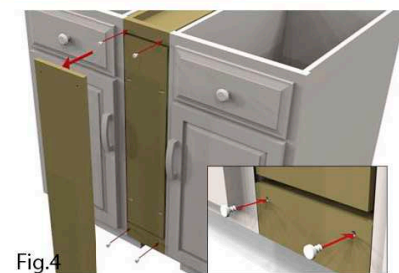

Fig.4

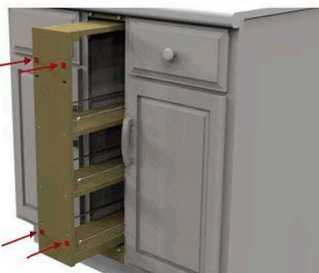

Fig.5

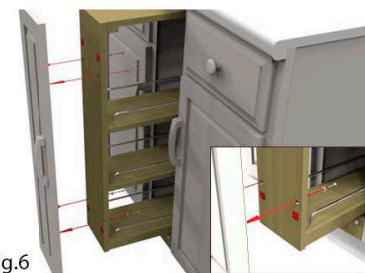

Fig.6