

## The button

Choose the Button to suit the screw type that works best with your panel material.

Use lime green Buttons with  $\varnothing 5\text{mm}$  countersunk wood screws. Use orange Buttons with  $\varnothing 6.2\text{mm}$  Euro screws (to fit  $\varnothing 5\text{mm}$  pilot holes).

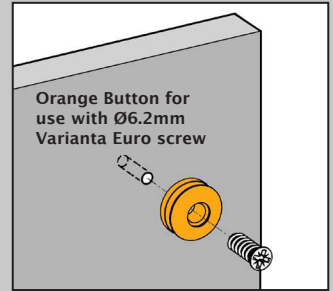
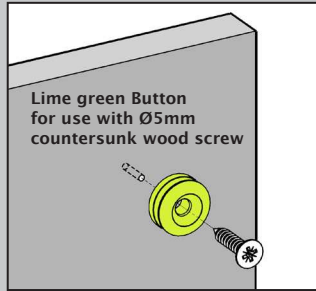

## Type 1 fix

The Type 1 Fix connects parallel panels and is ideal for applications where strength and security are paramount.

Engage the Buttons in the Fixes and slide the panel down by 15mm until Button-fix goes 'click'. The Type 1 Fix can also be configured for sideways assembly.

When surface-mounted, the Type 1 Fix creates an 8mm gap between the two attaching panels.

Alternatively, you can rebate the Type 1 Fix, to reduce the gap between the two attaching panels to only 3mm.

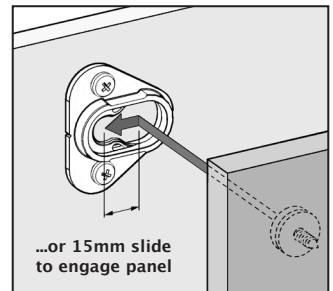
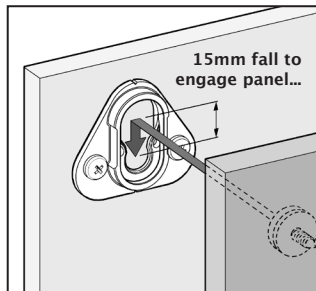
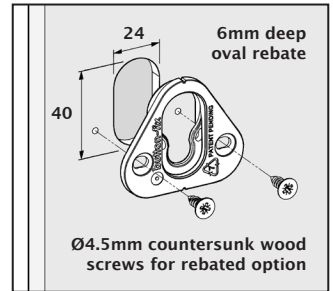
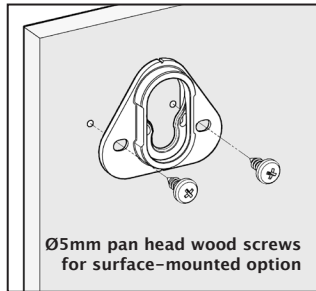

## Type 2 fix

The Type 2 Fix connects panels at  $90^\circ$  with a simple push/pull fit. It is ideal for applications where the emphasis is more on ease of fit and less on strength. Unlike Type 1, the Type 2 Fix does not require a 15mm drop-down engagement.

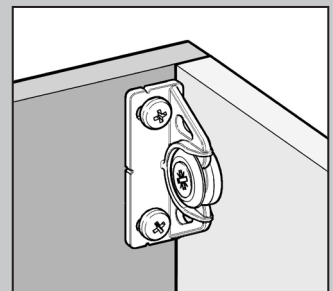
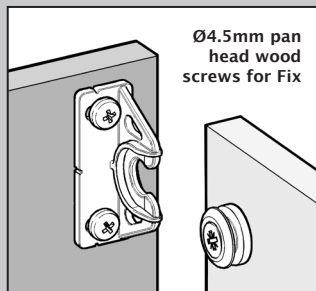

[www.button-fix.com](http://www.button-fix.com)

Visit our website for full instructions, safety notes and load test reports. For critical applications it is essential to perform your own load tests with your materials and fixings.

## Type 1 flush fix

The Type 1 Flush Fix is for applications where panel-panel contact is required and fits a simple oval rebate.

It can be rebated into the edge of a panel of at least 28mm thick (as shown) or the face of a panel of at least 18mm thick.

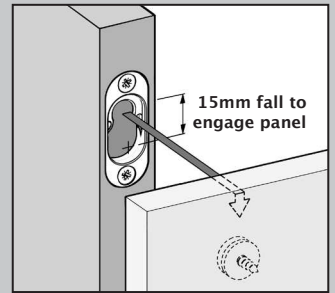
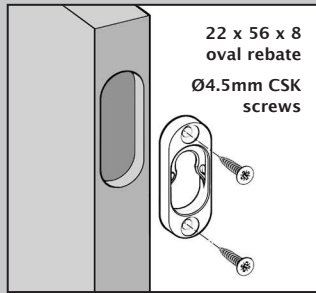

## Type 1 bonded fix

The Type 1 Bonded Fix is for applications where screw-fixing to the panel is not possible and bonding is the preferred option. As well as surface-mounting, the Fix may be rebated for additional strength and ease of alignment.

The Fix is manufactured in ABS plastic and there are many structural adhesives suitable for bonding it to a wide range of panel materials.

A self-adhesive Fix-pad may be ordered separately. We recommend using these in a rebated configuration, to avoid possible creep under loading.

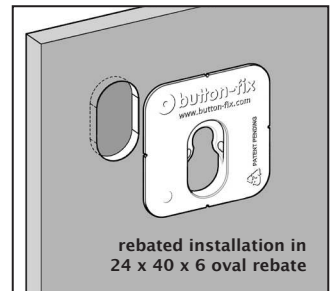
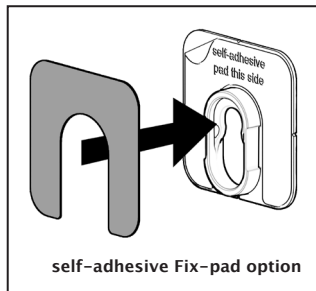
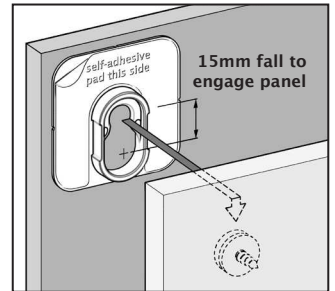

## Marker accessories

Button and Fix markers may be ordered separately to quickly and accurately align the Button-fix installation. The markers will leave indents in the mating panel surface, which can be used as guides. Visit our website to see the full range of accessories.

