

**COVER CAP - HEAVY DUTY**  
**300.5200.BLK/MAL**

**DESCRIPTION & SPECIFICATIONS**

The Heavy Duty Cover Cap attaches the hook to the track and creates an attractive look. Caps can be custom branded to feature the name or logo-type of your closet shop.

SIZE & CAPACITY | Heavy Duty

AVAILABLE FINISHES |



Matte Aluminum, Black.

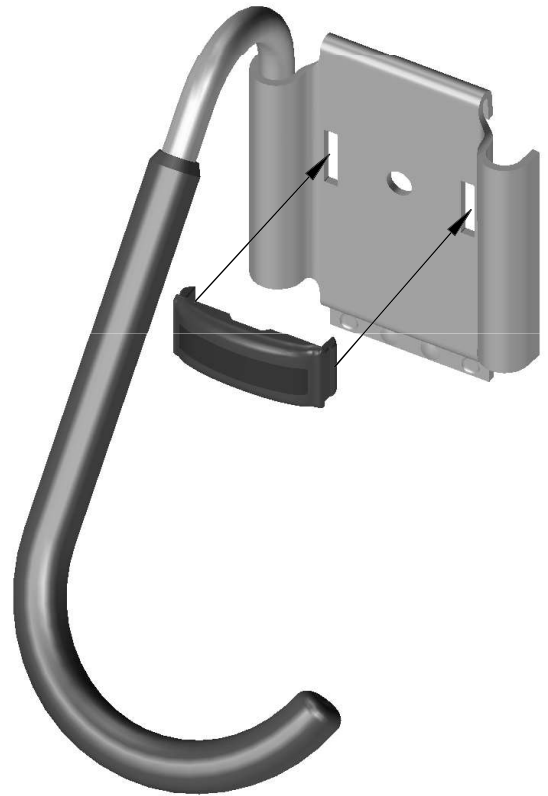
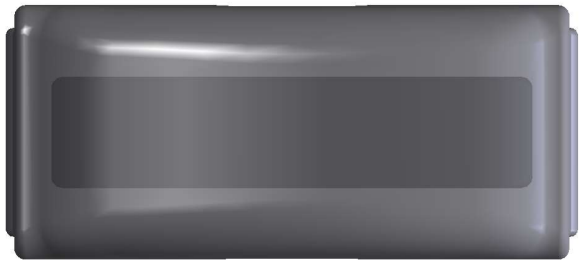

**INSTRUCTIONS & SPECIFICATIONS**

- STEP 1: Align the cap with the slots on the hook base.
- STEP 2: Press the cap into the slots. Hook is now fixed in place.

FINISH	CODE (FIN)
MATTE ALUMINUM	MAL
BLACK	BLK